

NOTES
All dimensions are shown in mm unless otherwise specified.
Drawings are not to be scaled. Only figured dimensions to be used.
The contractor must check and verify all dimensions on site before commencement of any work.
This drawing is protected under the Copyright Act and thus it is not to be reproduced or copied in whole or in part without author's consent.

SHEET INDEX

| | |
|---|--|
| 0 | General (symbols legend, notes, list, cover) |
| 1 | Plans |
| 2 | Elevations |
| 3 | Sections |
| 4 | Large-Scale Views |
| 5 | Details |
| 6 | Schedules & Diagrams |
| 7 | 3D Impressions |

KEY PLAN

REVISIONS

| Date | Descriptions |
|------|--------------|
| | |

CLIENT
KENGEN,
P.O. BOX 47936, 00100,
NAIROBI.

Client's Signature: _____

PROJECT TITLE

PROPOSED KENGEN GEO-THERMAL TRAINING CENTRE AT NAVASHA ON PLOT L.R. NO. FOR KENGEN

**- LABORATORY BLOCK -
PROPOSED GROUND FLOOR PLAN -
LABORATORIES - PHASE 01**

| | | |
|-------------------------|-----------|-----------|
| Drawn: C. Mwangi | Date: | Revision: |
| Scale: 1:100 | Job no. | 22106 |
| Approved: Karuki Muraya | Sheet No. | A101 |

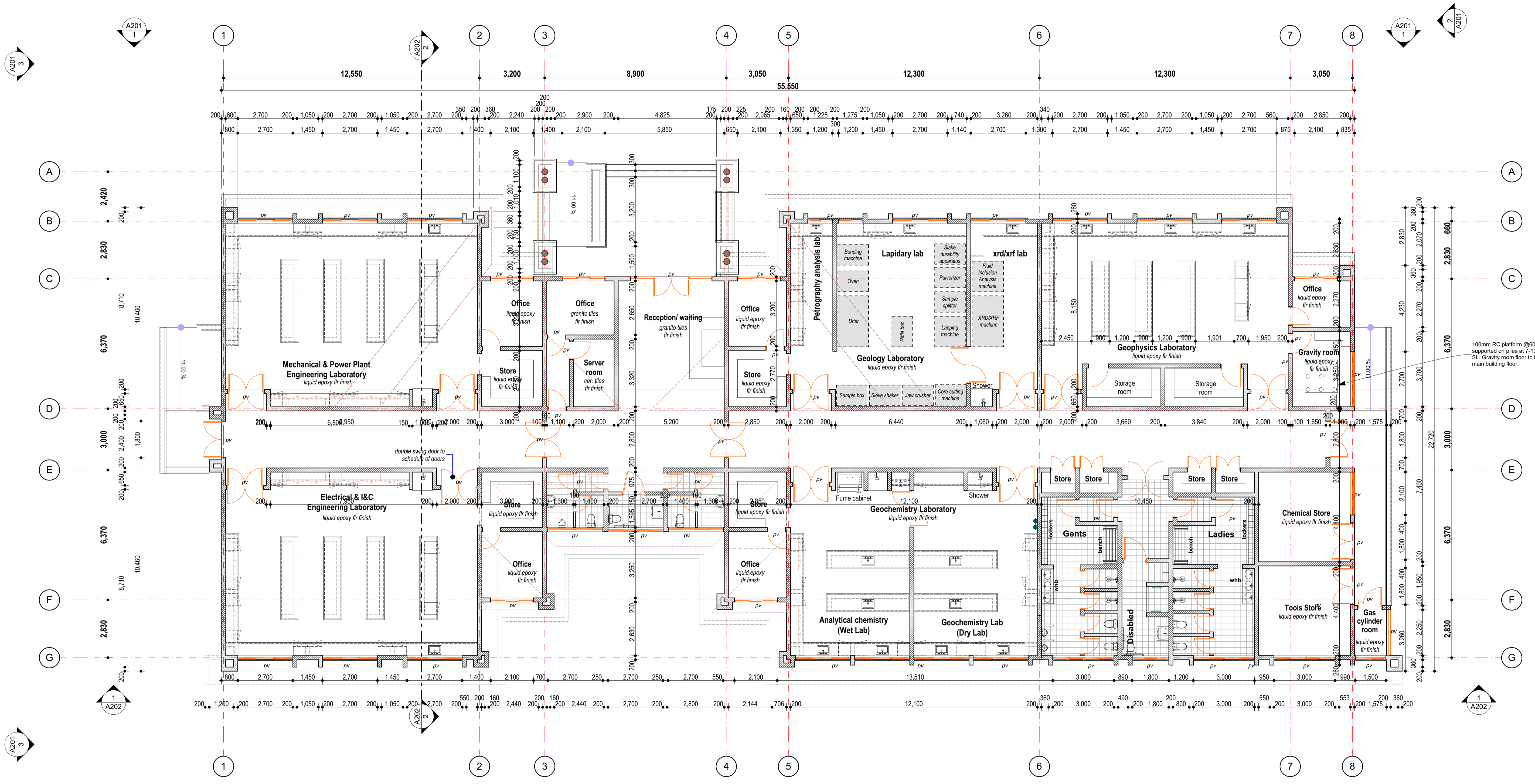

1 GROUND FLOOR PLAN - LABORATORIES - PHASE 01